

# Heller

# MIRAGE III E/RD

## 30422



## Français

Le prototype du Mirage III E effectue ses essais le 5 avril 1961. C'est une version d'attaque au sol et d'appui tactique. Le Mirage III R est une version de reconnaissance dont la pointe est dotée de cinq caméras, le Mirage III RD avec caméra panoramique et système radar plus performant. Le Mirage 5, spécialement étudié pour l'exportation, est un Mirage III E très simplifié.

<b>Longueur</b>	15,03 m
<b>Envergure</b>	8,22 m
<b>Hauteur</b>	4,25 m
<b>Moteur</b>	SNECMA Atar 9 C-3 de 6400 kgp
<b>Vitesse maximale</b>	Mach 2,2 à 12000 m

## English

The prototype of the Mirage III E made its test flights on the 5th April 1961. It is a ground attack and tactical support version. The Mirage III R is a reconnaissance version and its nose cone is equipped with five cameras, the Mirage III RD with panoramic camera and more powerful radar system. The Mirage 5, especially designed for export, is an extremely simplified version of the Mirage III E.

<b>Length</b>	15.03 m
<b>Wingspan</b>	8.22 m
<b>Height</b>	4.25 m
<b>Engine</b>	SNECMA Atar 9 C-3, 6400 kgp
<b>Maximum speed</b>	Mach 2.2 at 12000 m

## Deutsch

Der Prototyp der Mirage III E absolvierte seine Testflüge am 5. April 1961. Es handelte sich um eine Version für den Bodenangriff und die taktische Unterstützung. Die Mirage III R war eine Aufklärungsversion, deren Nasenspitze mit 5 Kameras ausgestattet war, die Mirage III RD mit Panoramakamera und leistungsfähigerem Radarsystem. Eine sehr vereinfachte Version der Mirage III E, die speziell für den Export entwickelt wurde, war die Mirage 5.

<b>Länge</b>	15,03 m
<b>Spannweite</b>	8,22 m
<b>Höhe</b>	4,25 m
<b>Motor</b>	SNECMA Atar 9 C-3 mit 6400 kgp
<b>Höchstgeschwindigkeit</b>	Mach 2,2 in 12000 m Höhe

## Español

El prototipo del Mirage III E realiza sus pruebas el día 5 de Abril de 1961. Se trata de una versión de ataque en tierra y apoyo táctico. El Mirage III R es una versión de reconocimiento cuya punta va dotada de cinco cámaras, el Mirage III RD con cámara panorámica y un sistema de radar más potente. El Mirage 5, especialmente diseñado para la exportación, es un Mirage III E muy simplificado.

<b>Longitud</b>	15,03 m
<b>Envergadura</b>	8,22 m
<b>Altura</b>	4,25 m
<b>Motor</b>	SNECMA Atar 9 C-3 de 6400 kgp
<b>Velocidad máxima</b>	Mach 2,2 a 12000 m

## Italiano

Il prototipo del Mirage III E ha fatto il suo volo di prova il 5 Aprile 1961. Si tratta di una versione d'attacco al suolo e di appoggio tattico. Il Mirage III E è invece una versione di ricognizione, la cui fusoliera è dotata di 5 telecamere, il Mirage III RD con telecamera panoramica e sistema radar più potente. Il Mirage 5, specificamente studiato per l'exportazione, è una versione molto semplificata del Mirage III E.

<b>Lunghezza</b>	15,03 m
<b>Apertura alare</b>	8,22 m
<b>Altezza</b>	4,25 m
<b>Motore</b>	SNECMA Atar 9 C-3 da 6400 kgp
<b>Velocità massima</b>	Mach 2,2 a 12000 m

## Nederlands

Het prototype van de Mirage III E voerde op 5 april 1961 zijn proeven uit. Het is een versie van de grondaanval en van de tactische steun. De Mirage III R is een verkenningsversie waarvan de neus met vijf camera's voorzien werd, de Mirage III RD met panoramische camera en krachtiger radarsysteem. De Mirage 5, speciaal bestudeerd voor de export, is een zeer vereenvoudigde Mirage III E.

<b>Lengte</b>	15,03 m
<b>Spanwijdte</b>	8,22 m
<b>Hoogte</b>	4,25 m
<b>Motor</b>	SNECMA Atar 9 C-3 van 6400 kgp
<b>Maxi snelheid</b>	Mach 2,2 tegen 12 000 m

11 Argent métallique Silver Metallic Silber metallisch	30 Vert foncé mat Dark Green Matt Dunkelgrün matt	33 Noir mat Black Matt Schwarz matt	34 Blanc mat White Matt Weiß matt	53 Gris métallique Gunmetal Metallic Grau metallisch	56 Aluminium métallique Aluminium Metallic Aluminium metallisch	64 Gris clair mat Light Grey Matt Hellgrau matt
77 Bleu marine mat Navy Blue Matt Marineblau matt	87 Gris acier mat Steel Grey Matt Stahlgrau matt	96 Bleu RAF mat RAF Blue Matt RAF Blau matt	99 Jaune citron mat Lemon Matt Zitronengelb matt	106 Gris océan mat Ocean Grey Matt Ozeangrau matt	110 Bois naturel mat Natural Wood Matt Naturholz matt	127 Gris fantôme US satiné US Ghost Grey Satin US-Schattengrau seidenmatt
130 Blanc satiné White Satin Weiß seidenmatt	321 Rouge transparent Red Transparent Rot transparent	325 Vert transparent Green Transparent Grün transparent	M1 80% 11 20% 56	M2 50% 11 50% 56	M3 95% 127 5% 130	M4 95% 130 5% 127
						M5 50% 34 10% 99 40% 110

2

Numéro de phase  
Step number  
Schrittnummer  
Número de fase

56

Référence de couleur  
Colour reference no  
Farbangabe  
Referencia de color

37

Numéro de pièce  
Part number  
Teilenummer  
Número de pieza

6

Numéro de decal  
Decal number  
Abziehbildnummer  
Número de calcomanía

- Si aucune teinte n'est spécifiée, peindre dans les couleurs de la version choisie. Se reporter aux pages 14-15 pour le détail du schéma de peinture.
- When no color is specified, paint the item with colors of chosen version. Refer to pages 14-15 for painting pattern.
- Wenn keine Farbe angegeben ist, Teile mit den Farben der gewählten Version bemalen. Beachten Sie die Seiten 14-15 für die Lackierung und Markierung.
- Cuando ningún color es especificado, pintarle con los colores del tema de la versión elegida. Vea las páginas 14-15 para obtener detalles de pintura.

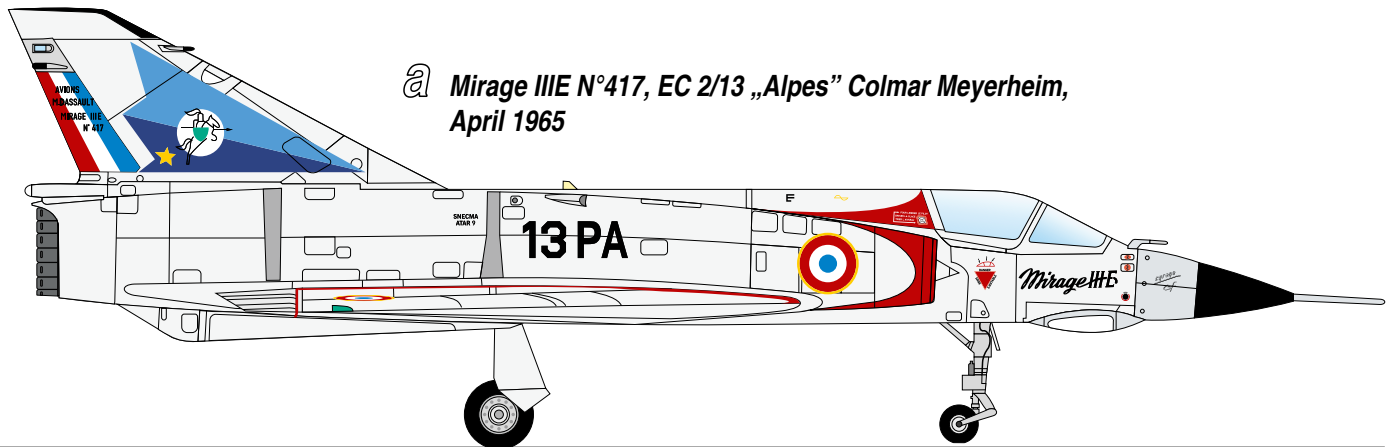

*a* **Mirage III E N°417, EC 2/13 „Alpes” Colmar Meyerheim,  
April 1965**

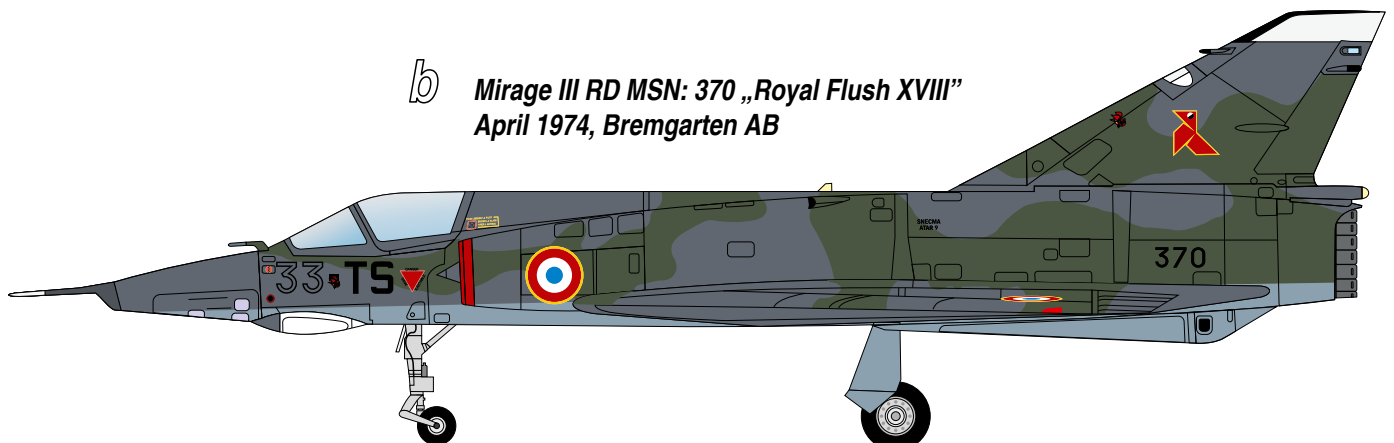

*b* **Mirage III RD MSN: 370 „Royal Flush XVIII”  
April 1974, Bremgarten AB**



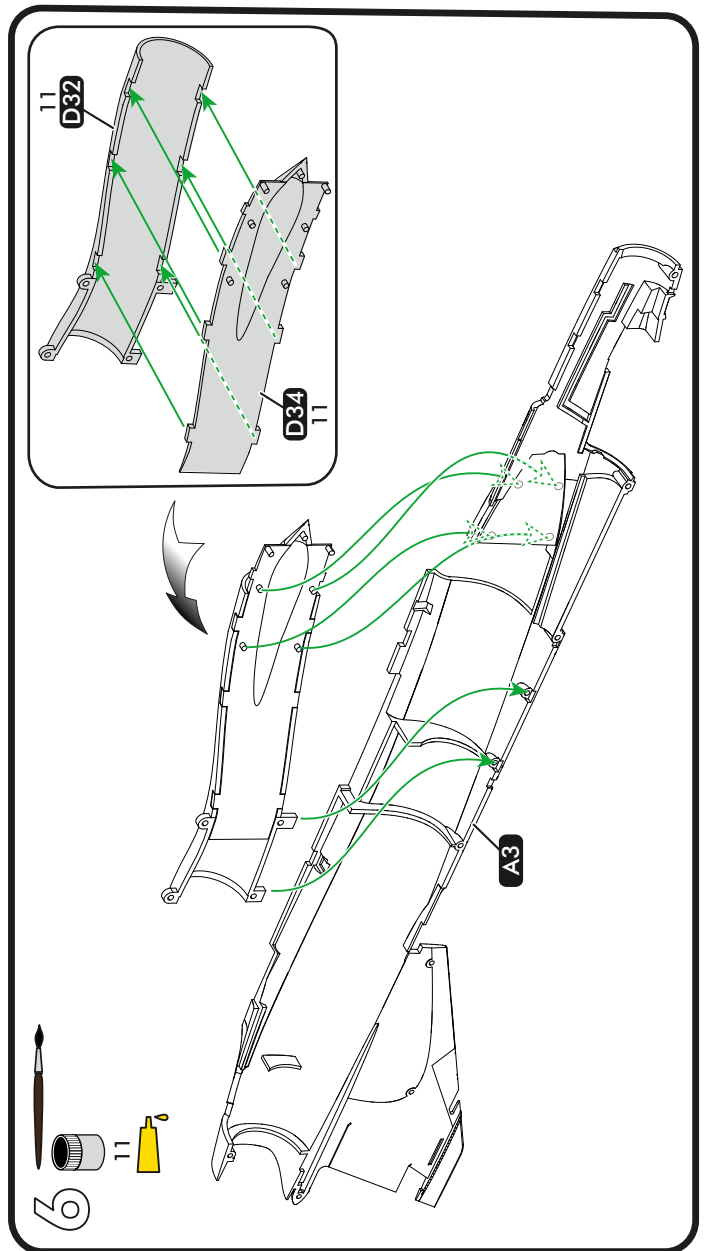
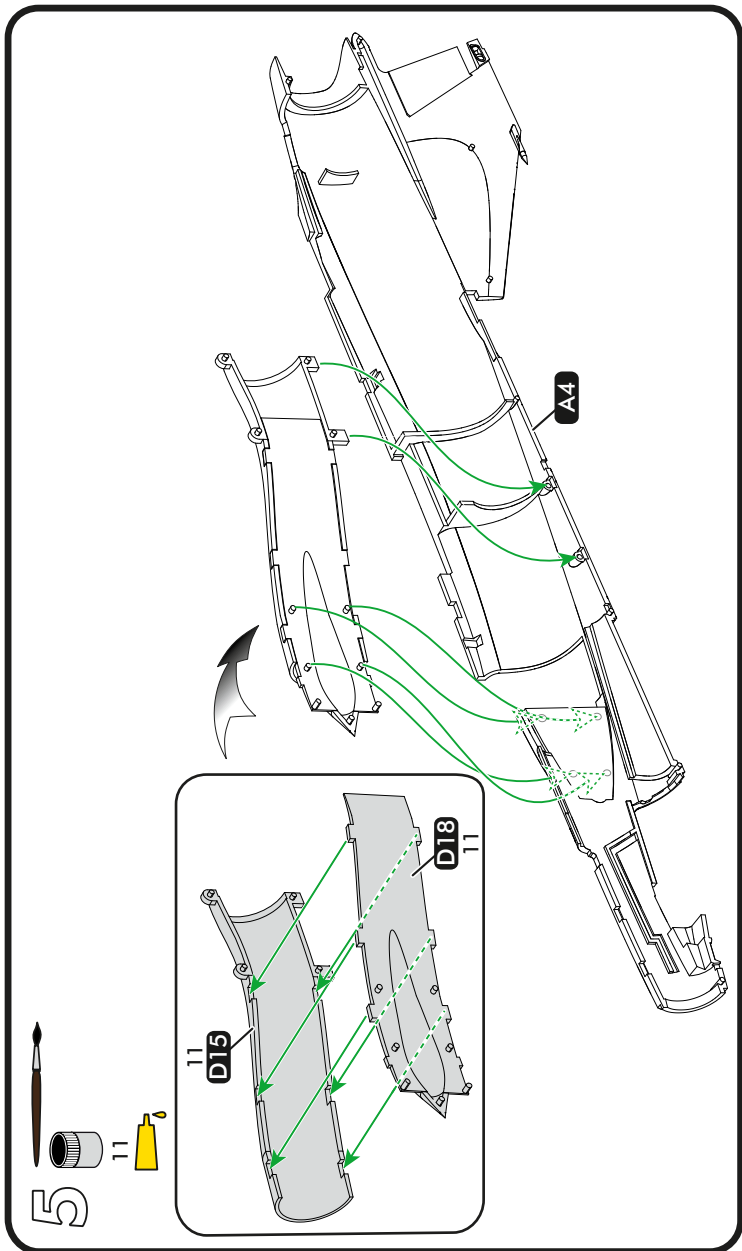
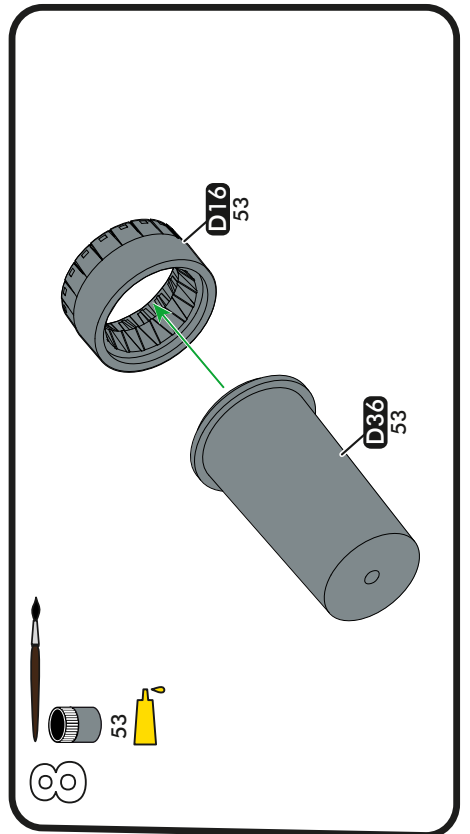
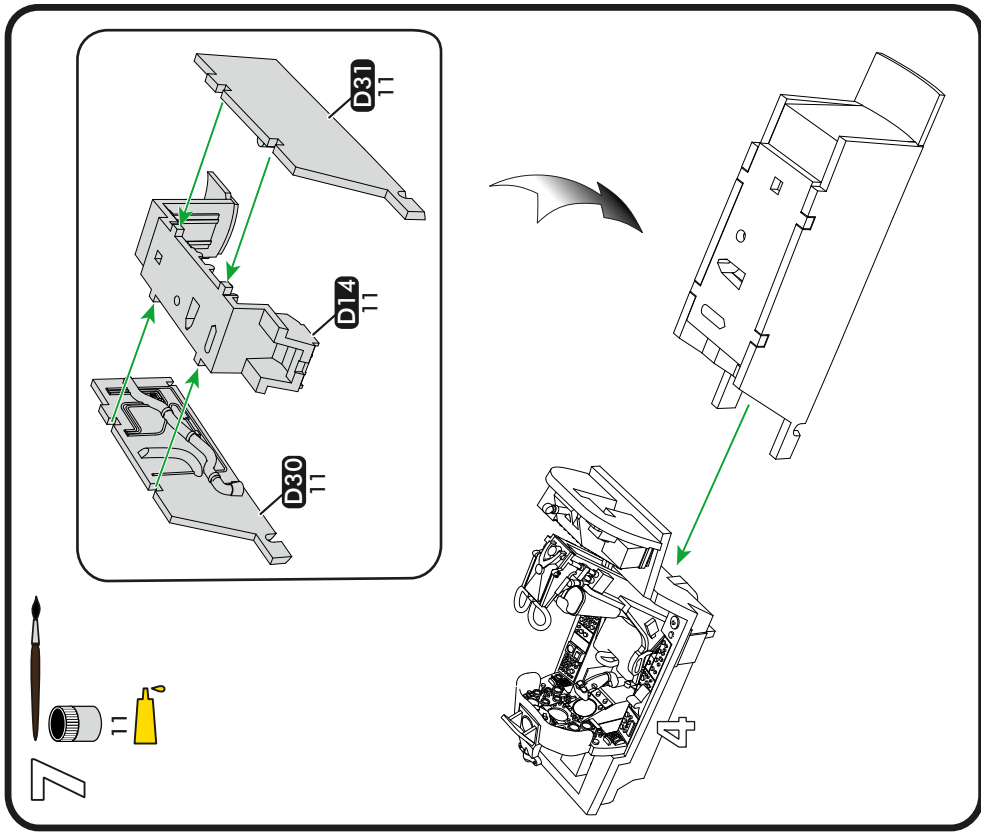

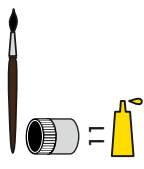
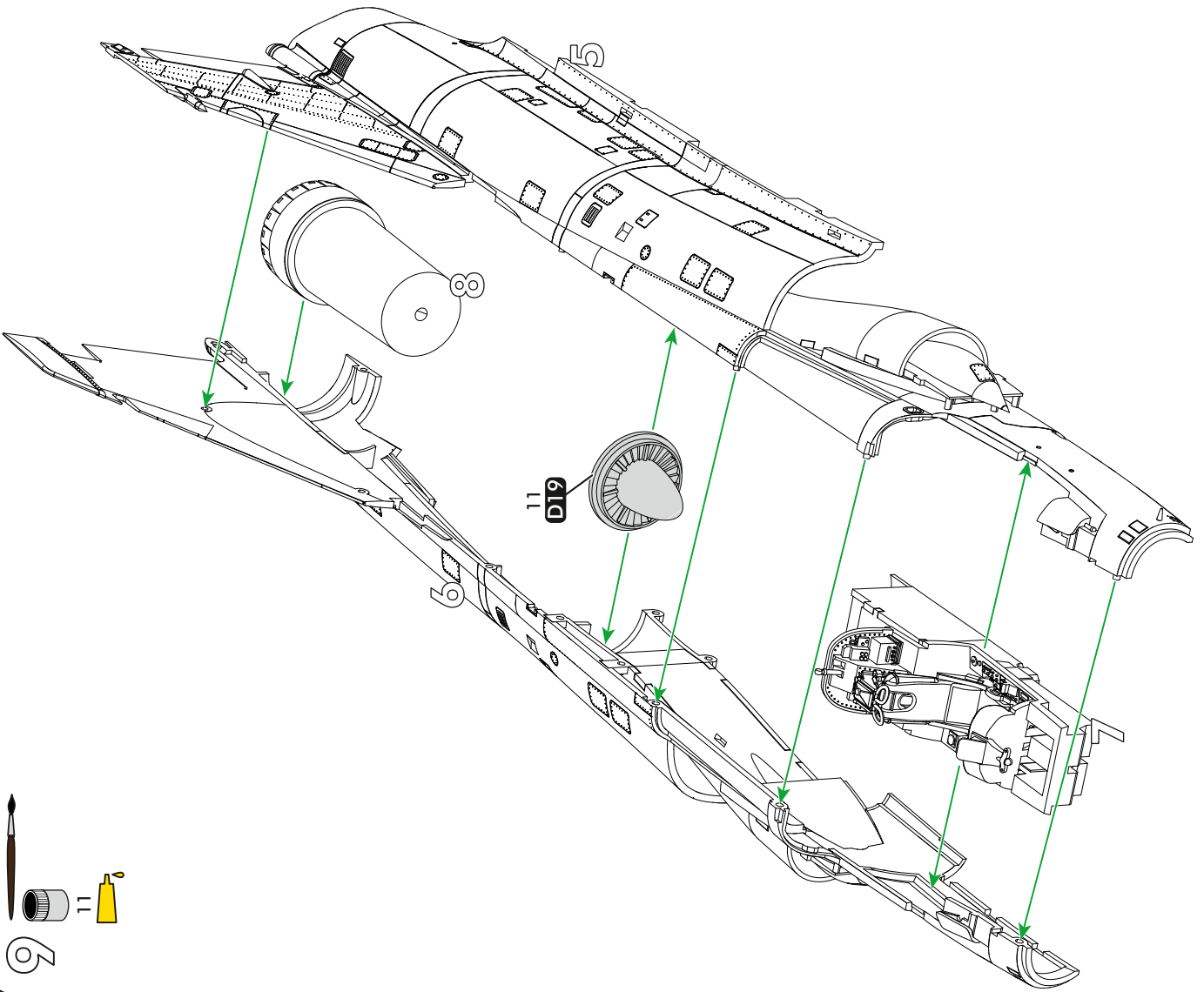

9

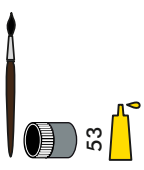
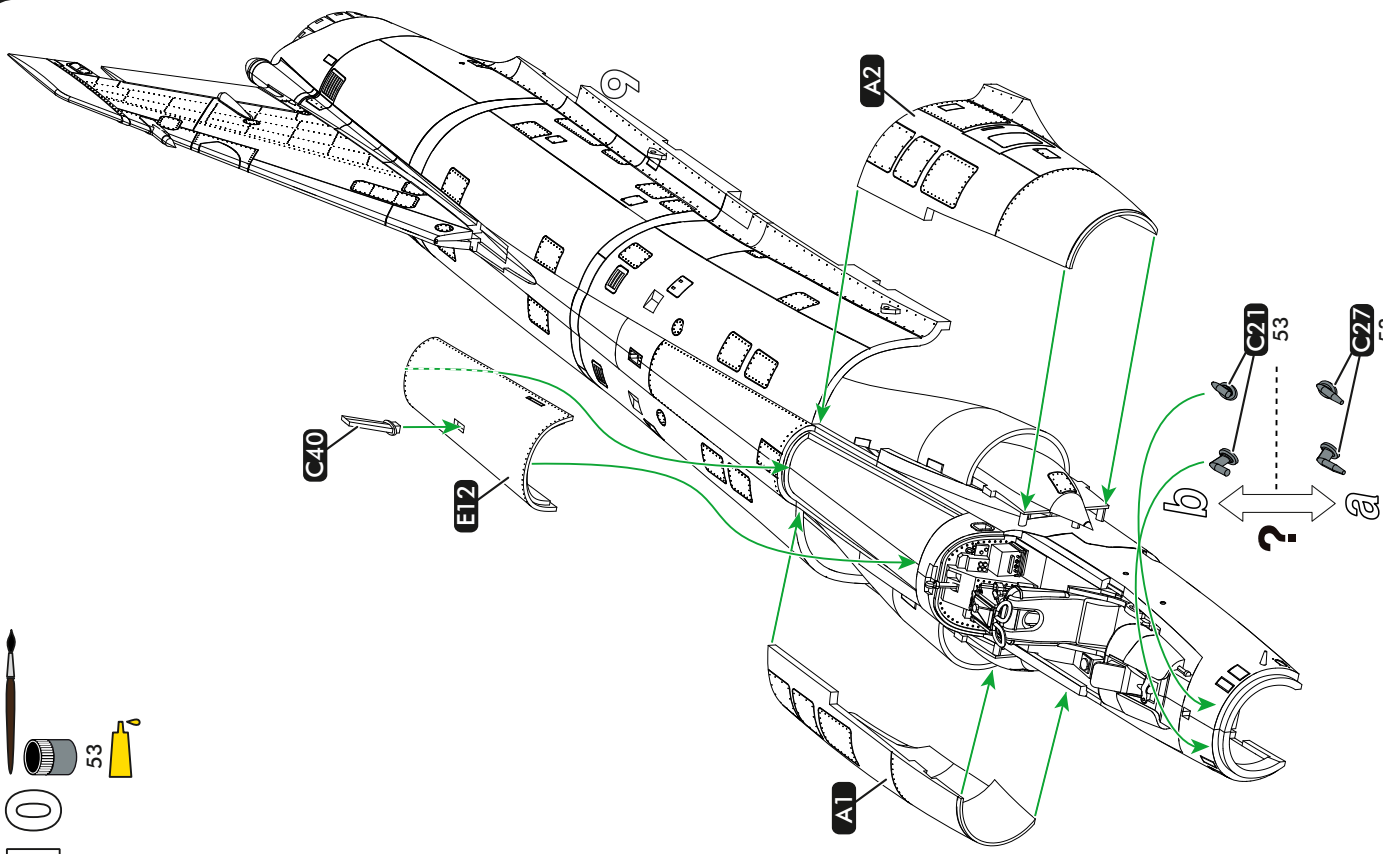

10

13

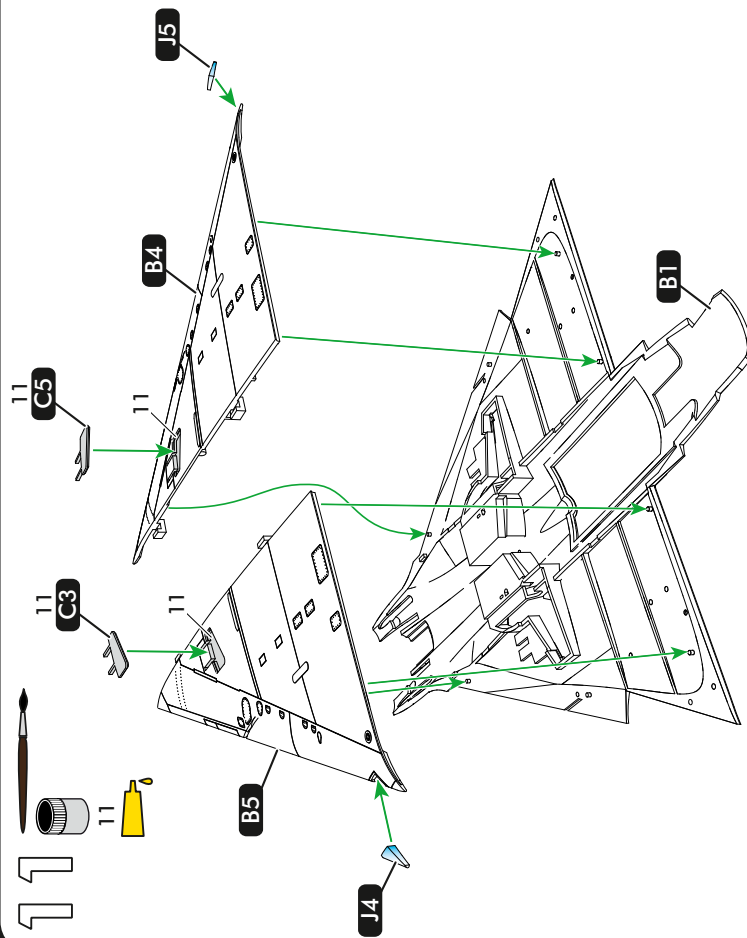
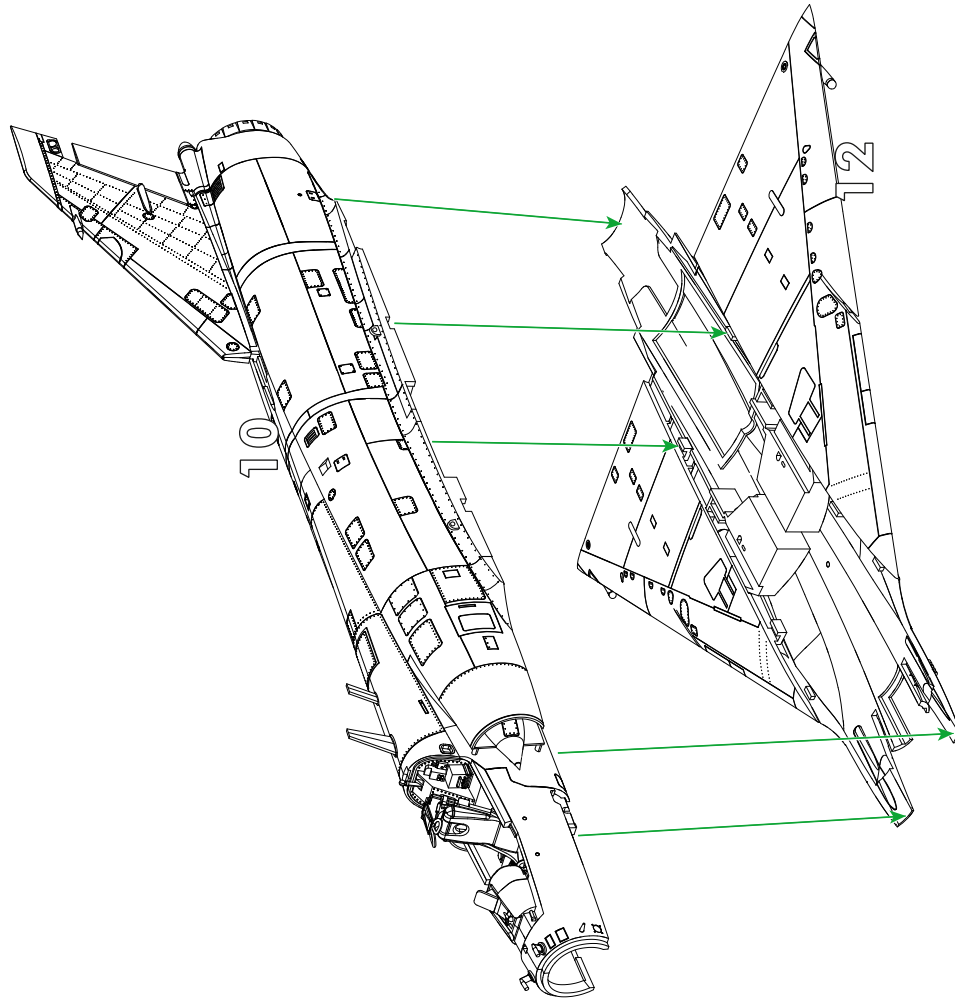

11

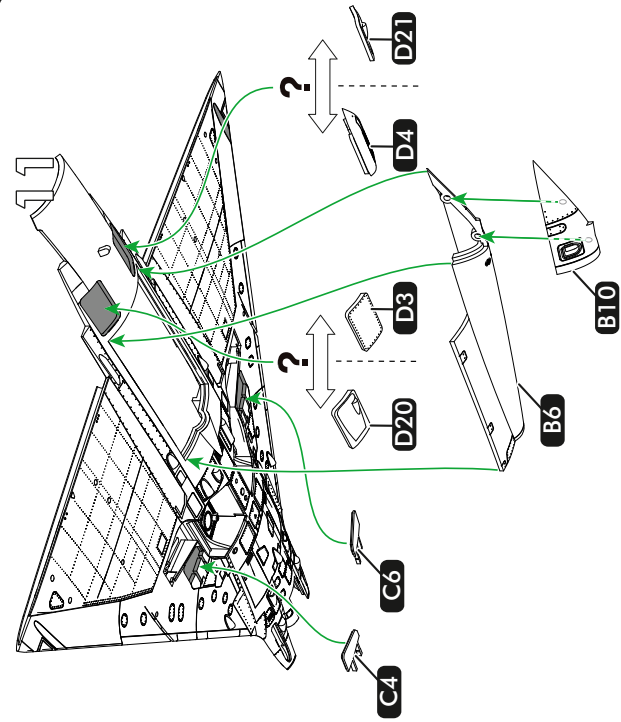
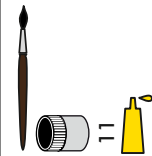

12



14

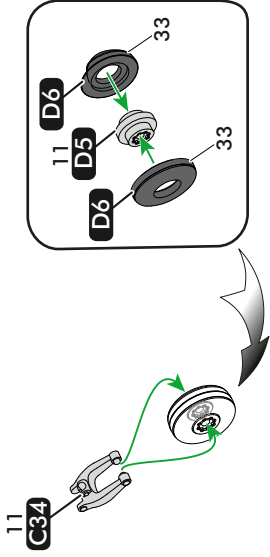
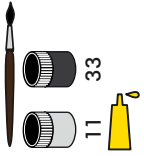

15

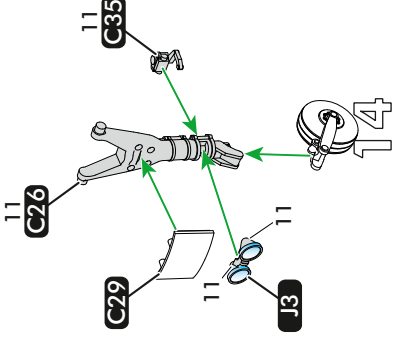
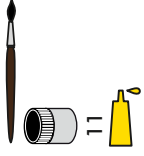

16

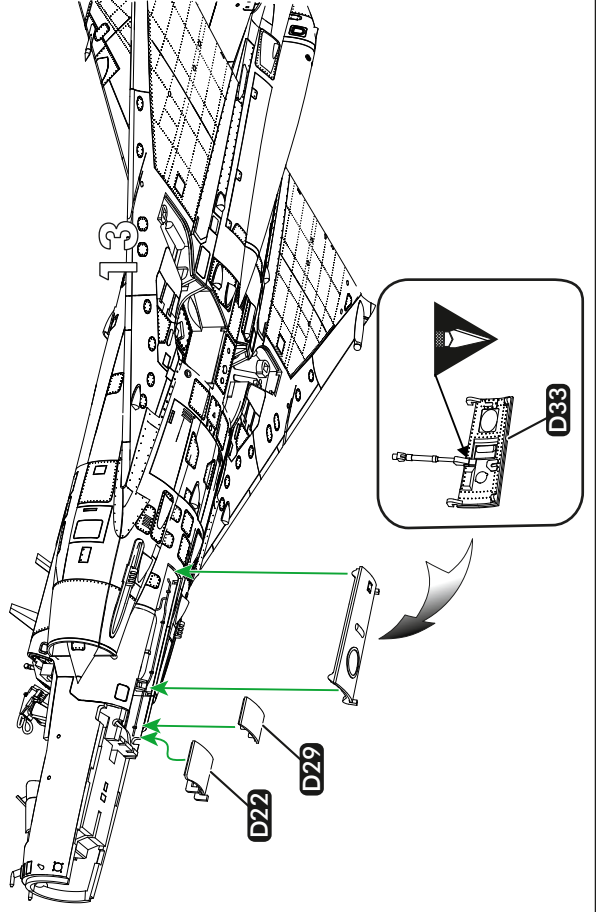
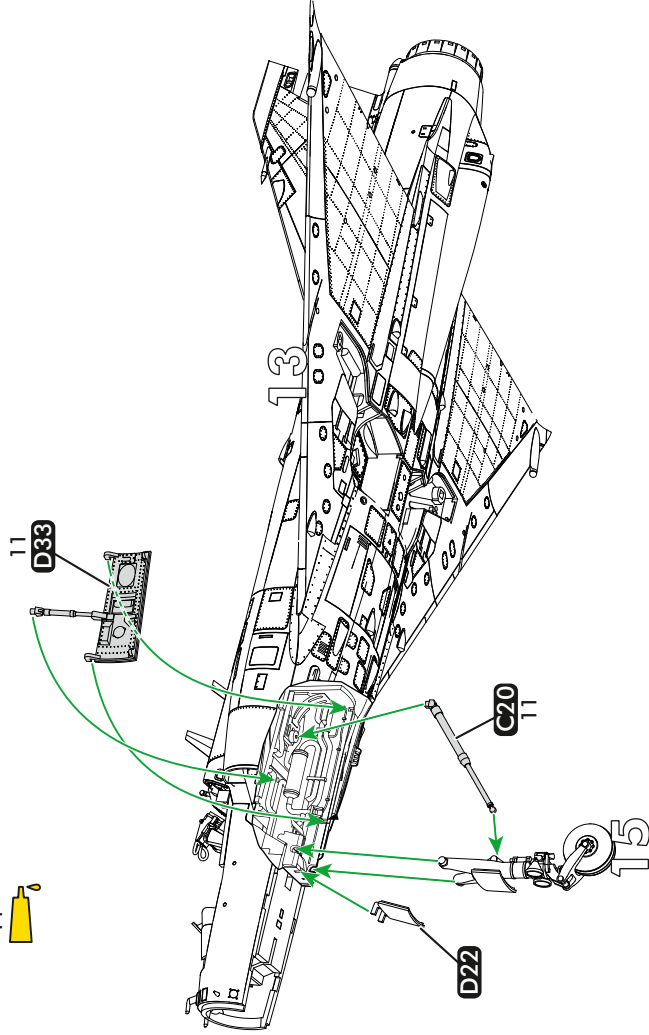
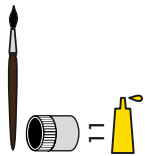



17

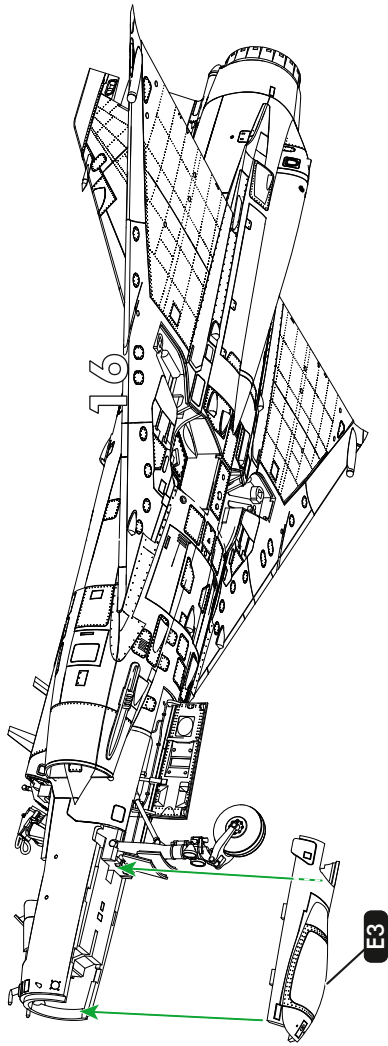

18

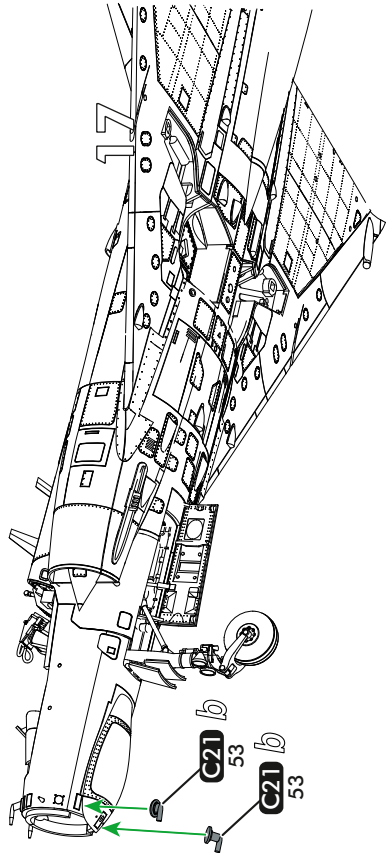

19

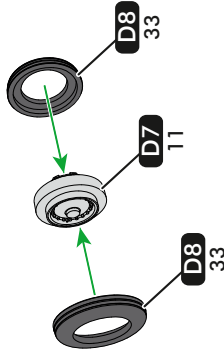
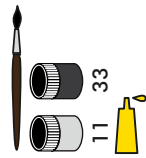

x2

20R

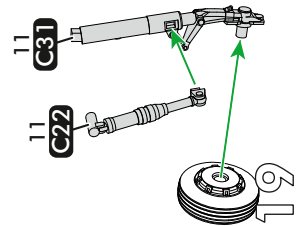
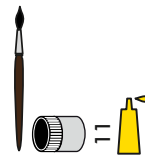

20L

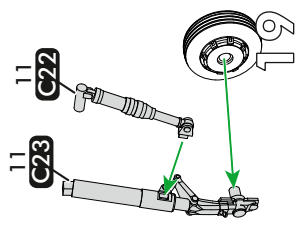
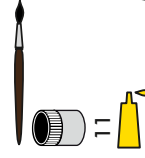

21R

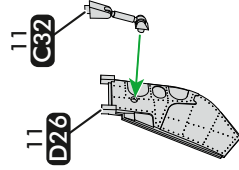
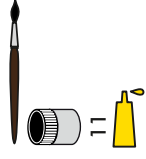

21L

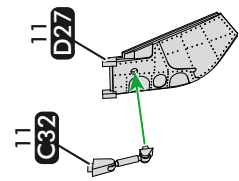
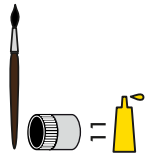

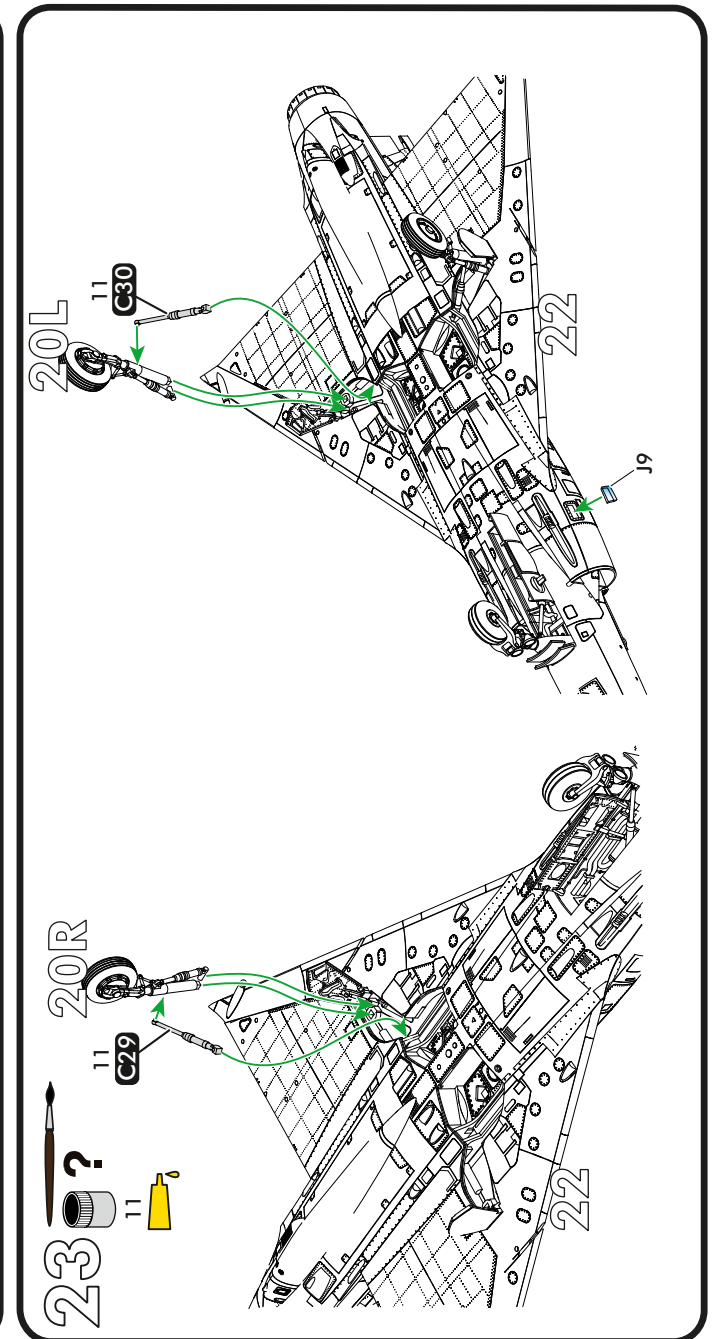
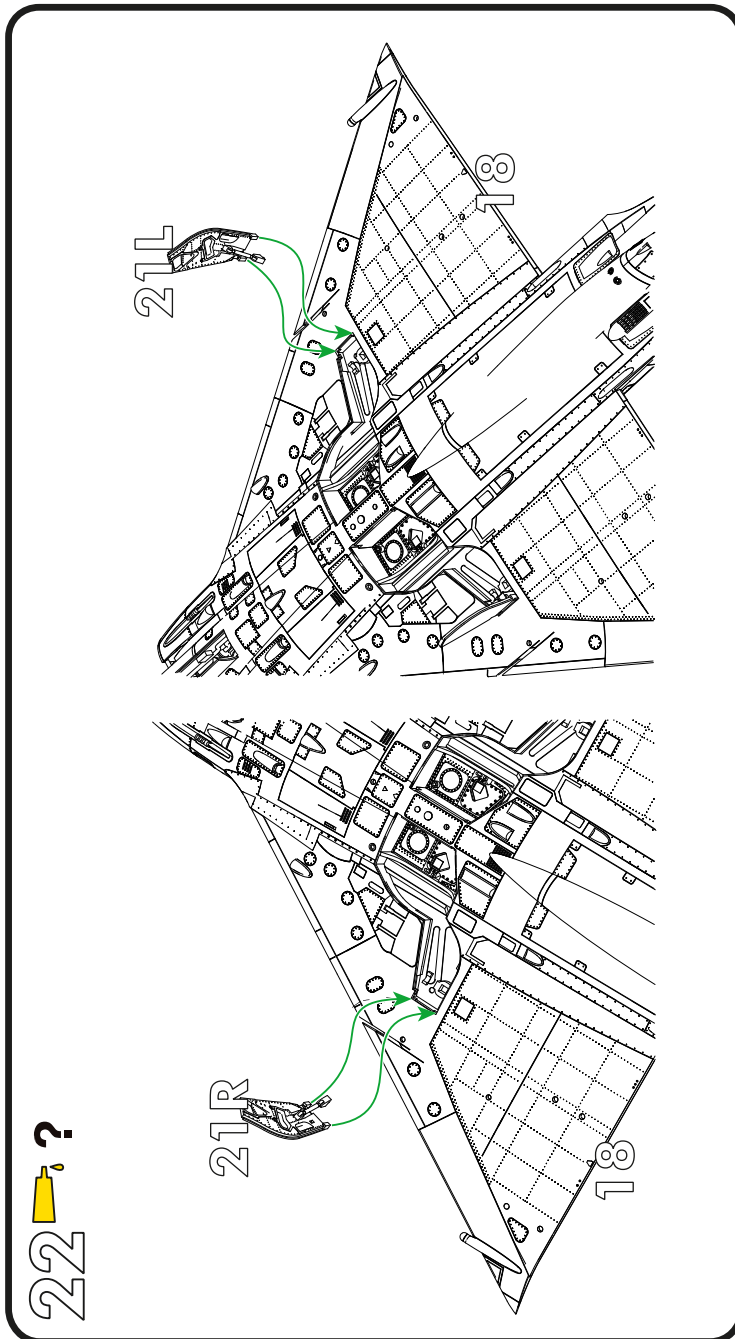
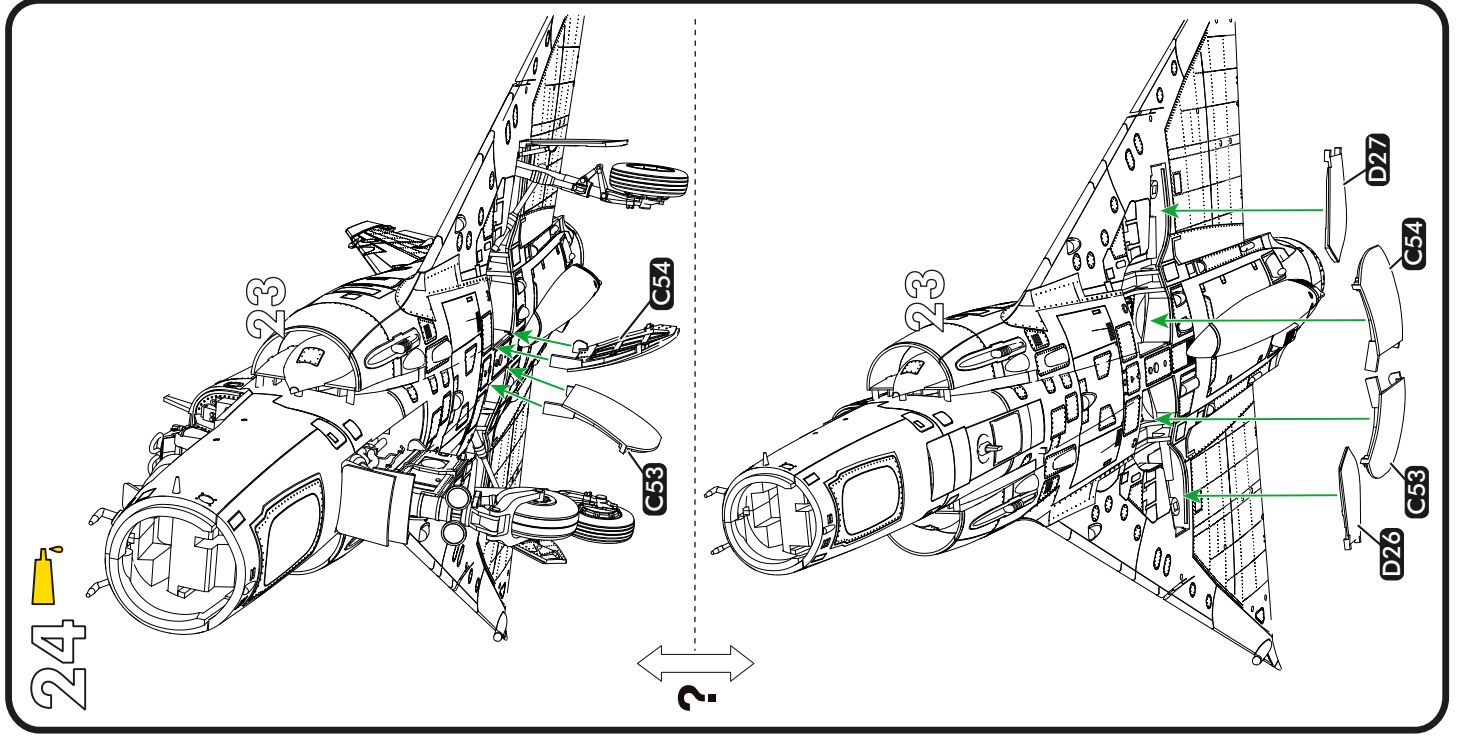

25

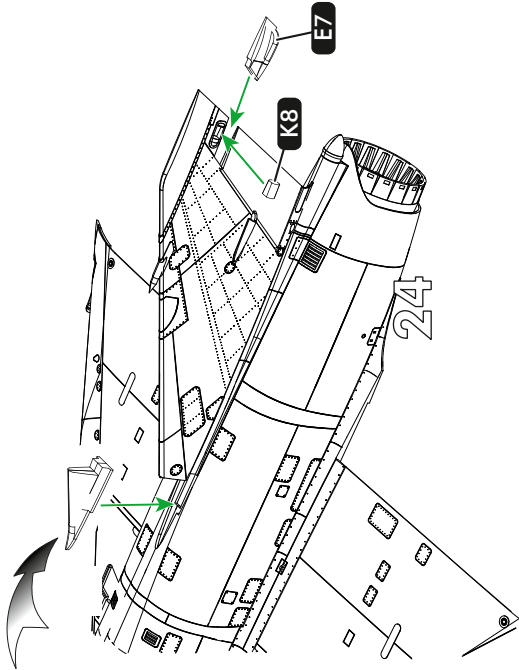
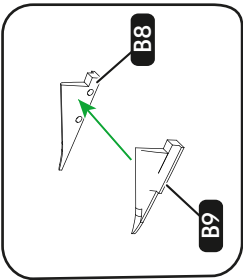

26



a ↔ b ?

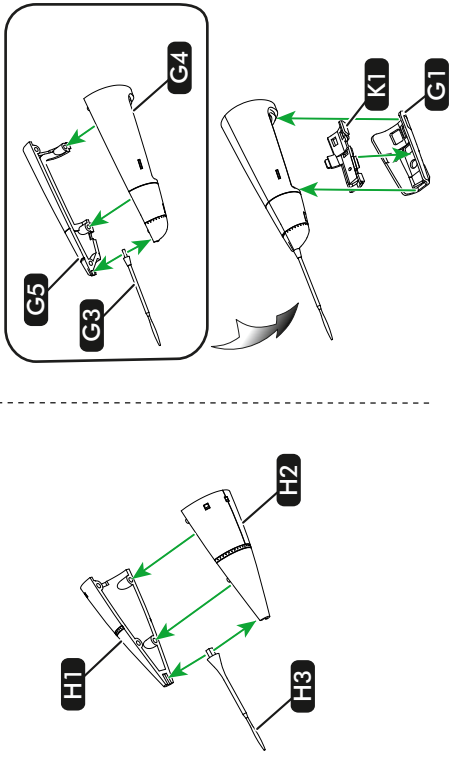

27

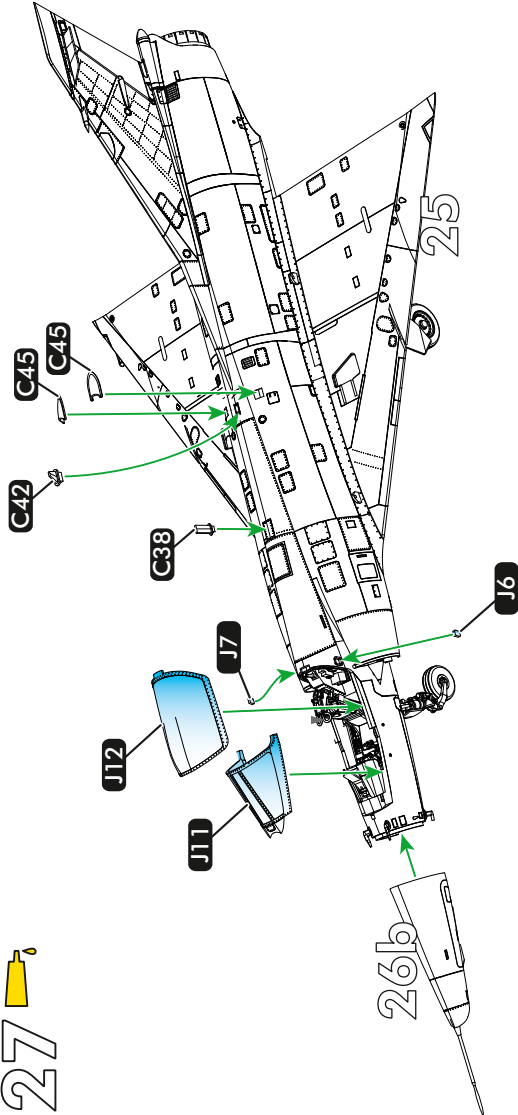

28



?

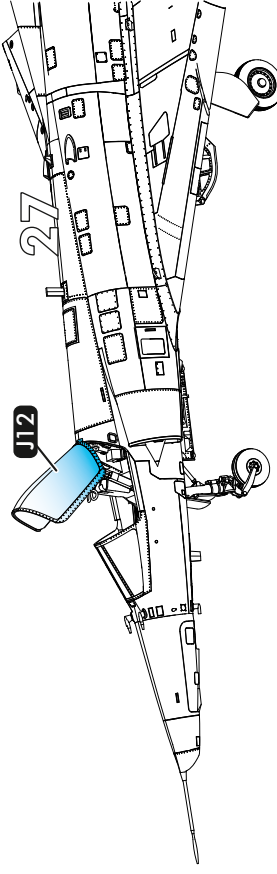

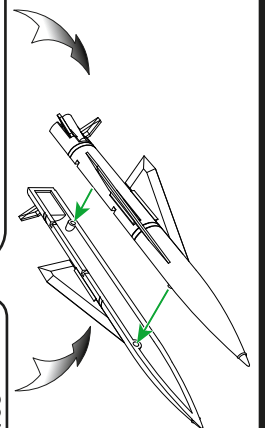
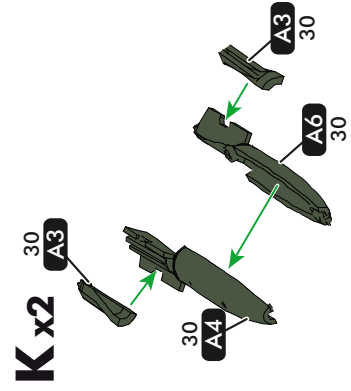
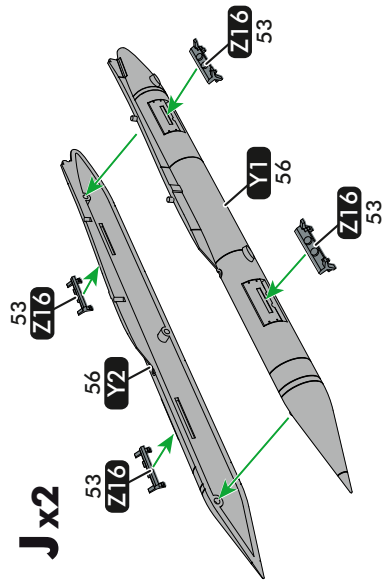
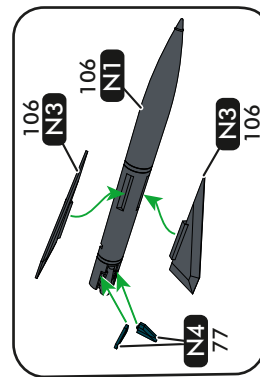
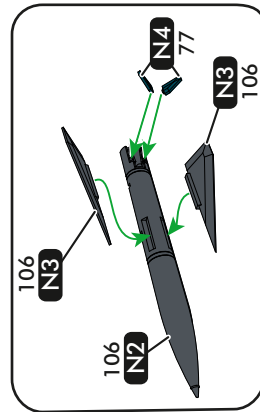
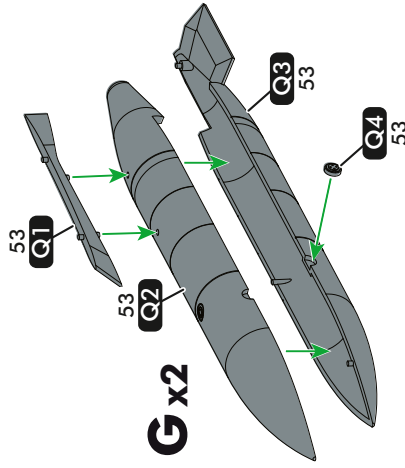
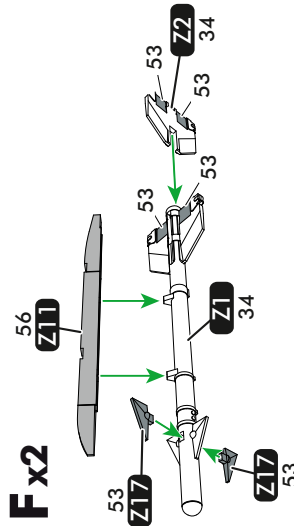
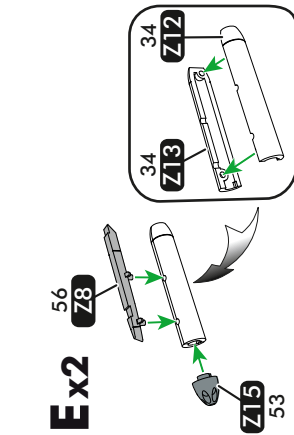
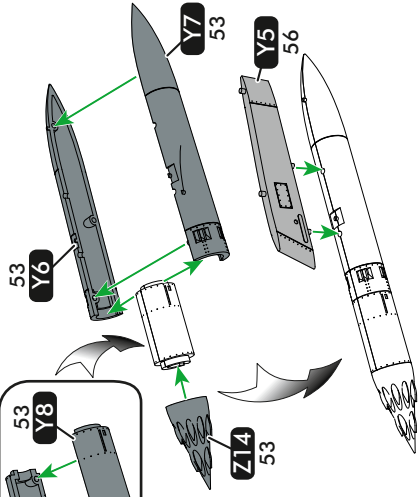
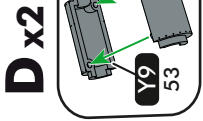
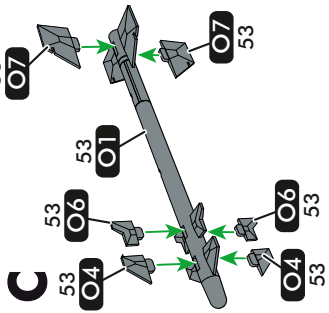
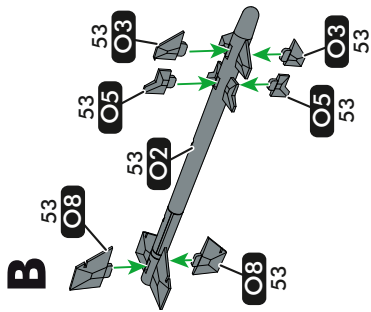
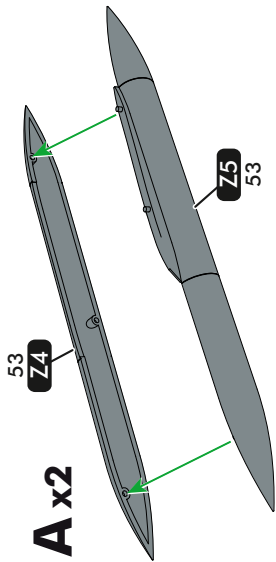
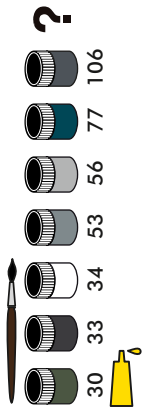

30

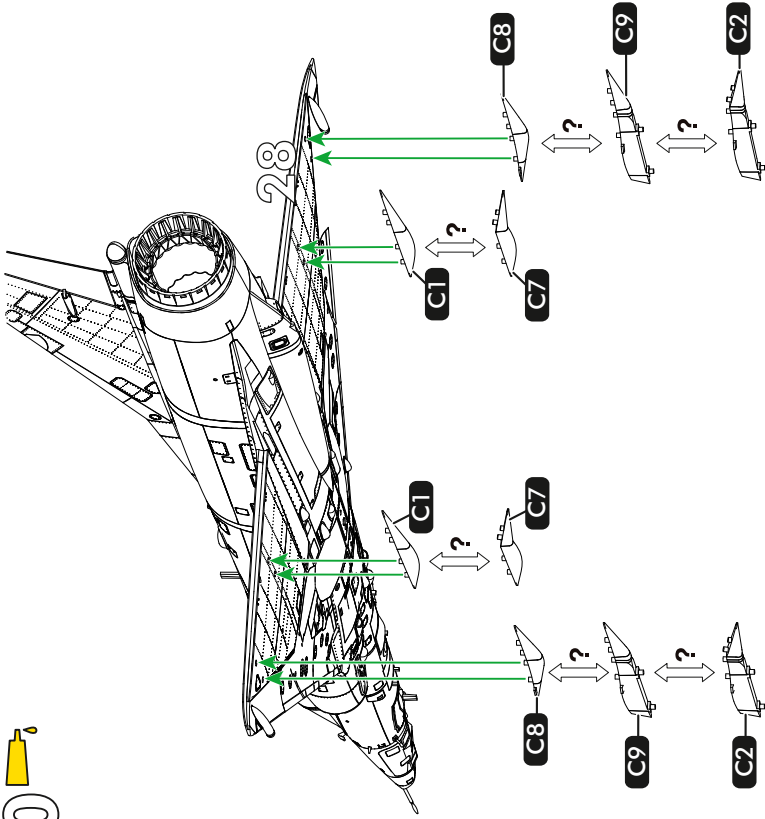

31

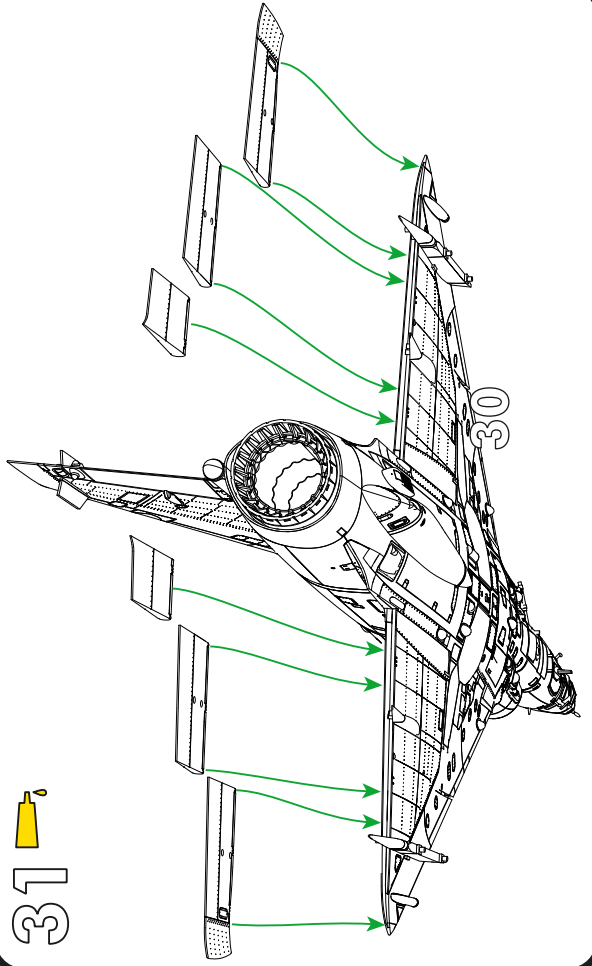

32

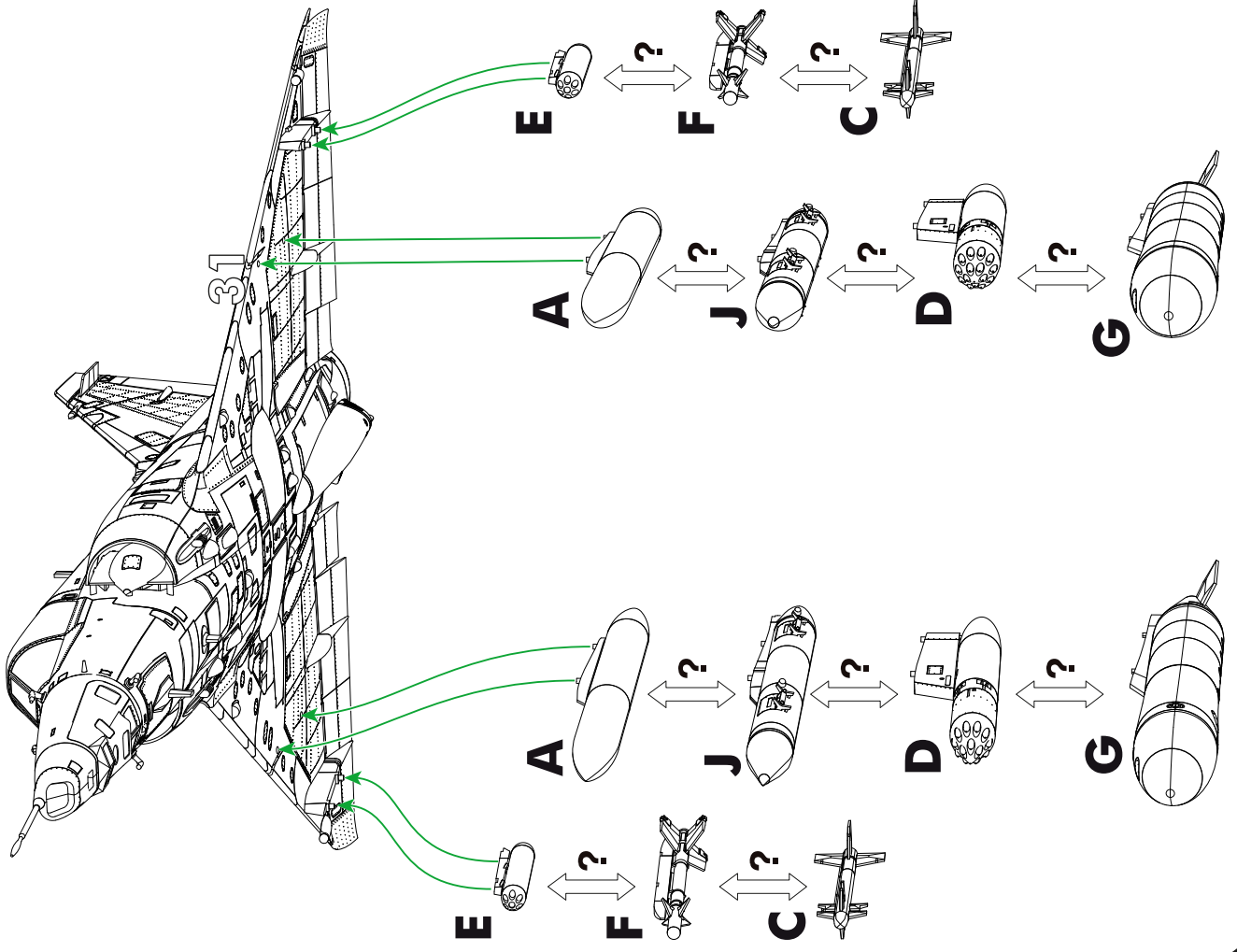

32

11 33 34 53 56 99 321 325 M1 M2  
 80% 11 50% 11  
 20% 56 50% 56

a *Mirage IIIE N°417, EC 2/13*  
*„Alpes” Colmar Meyerheim,*  
*April 1965*

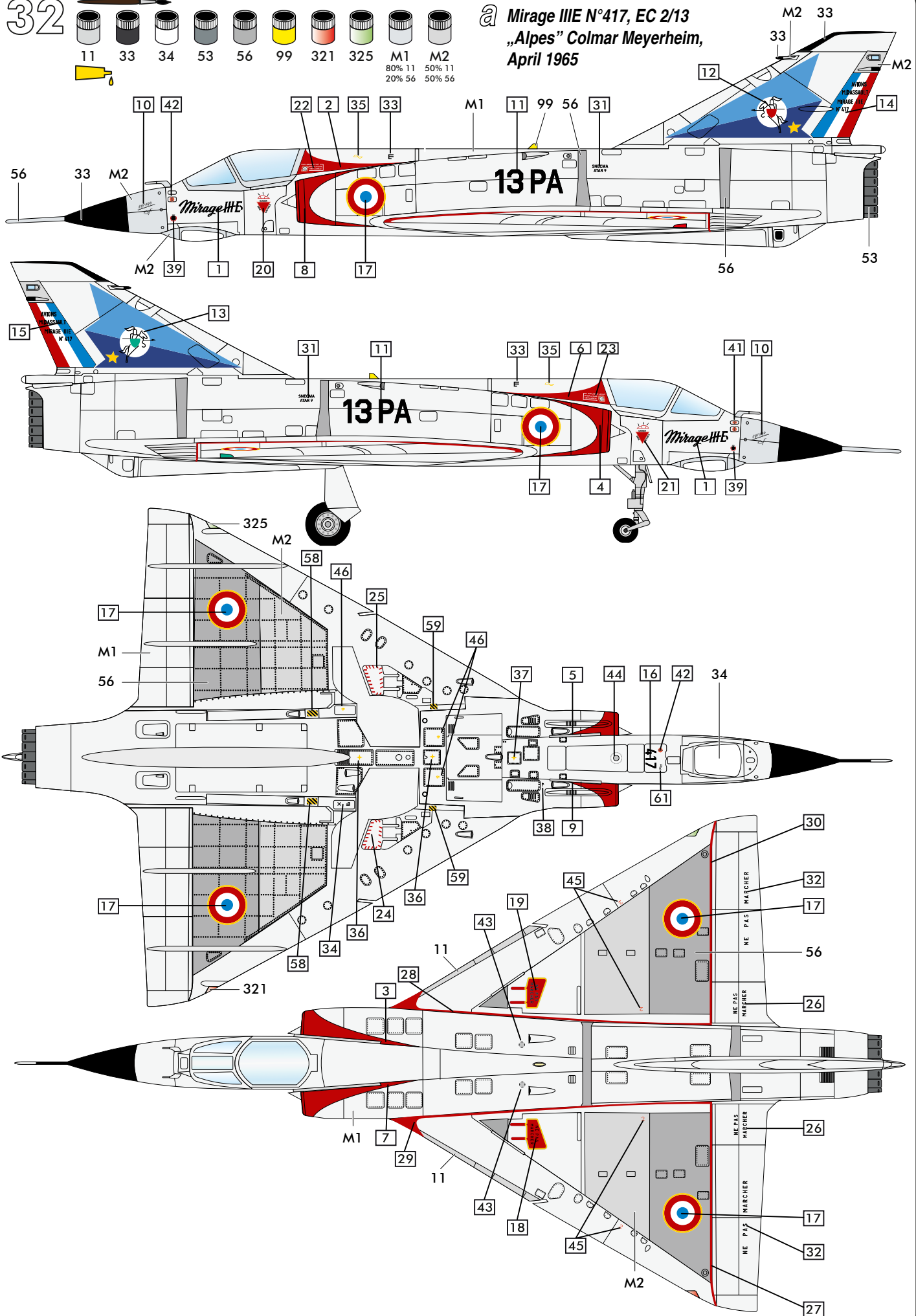

33

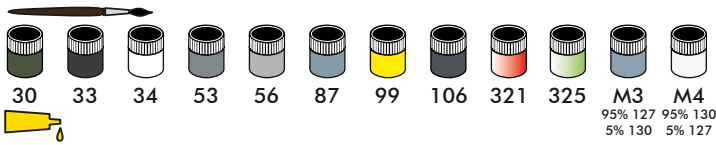

*b* **Mirage III RD MSN: 370**  
**„Royal Flush XVIII”,**  
**April 1974**  
**Bremgarten AB**

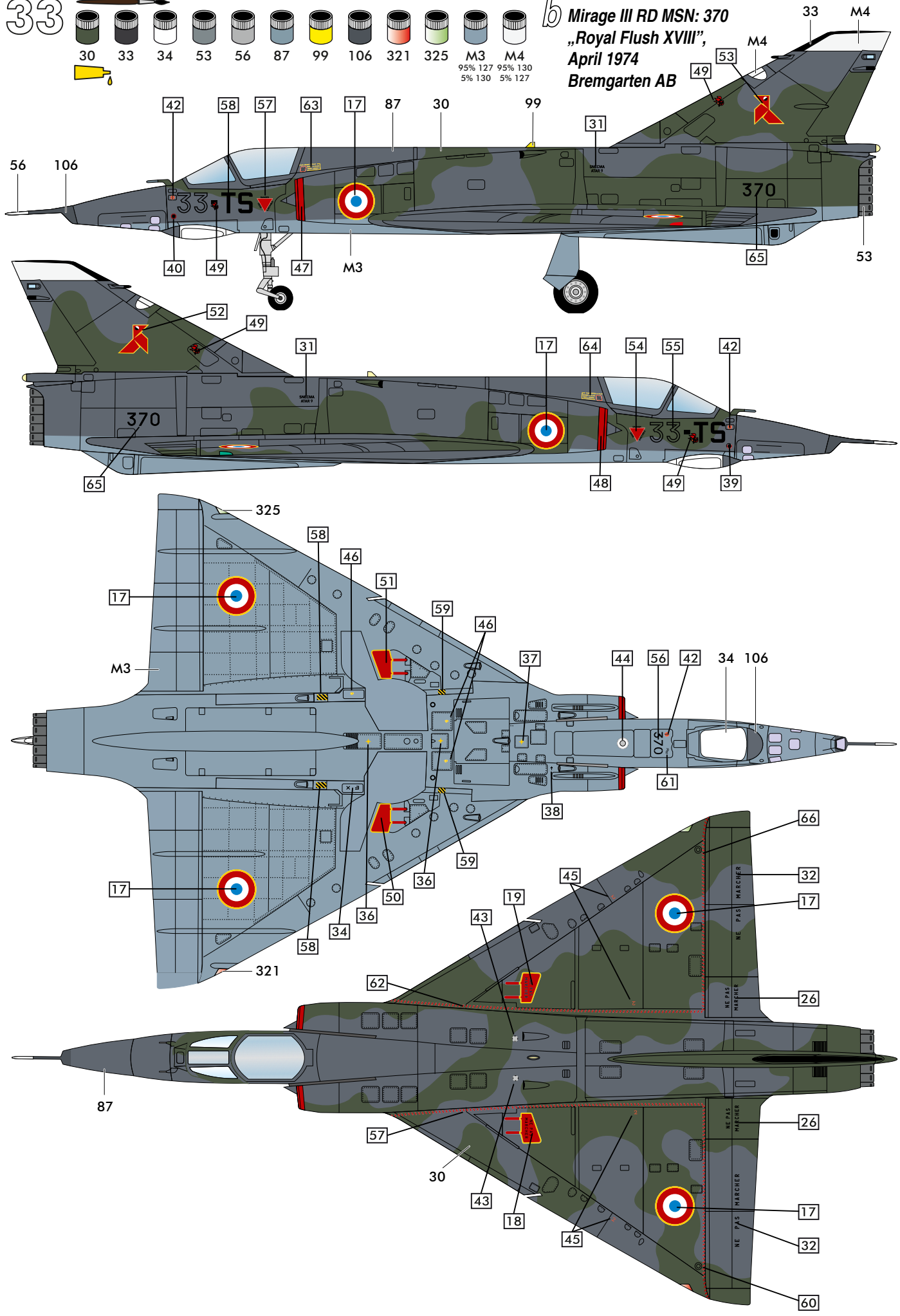

# VISITEZ-NOUS EN LIGNE !

VISIT US DIGITALLY!  
BESUCHEN SIE UNS DIGITAL!

 [www.heller.fr](http://www.heller.fr)

 [instagram.com/heller.fr](https://www.instagram.com/heller.fr)

 [facebook.com/heller.fr](https://www.facebook.com/heller.fr)

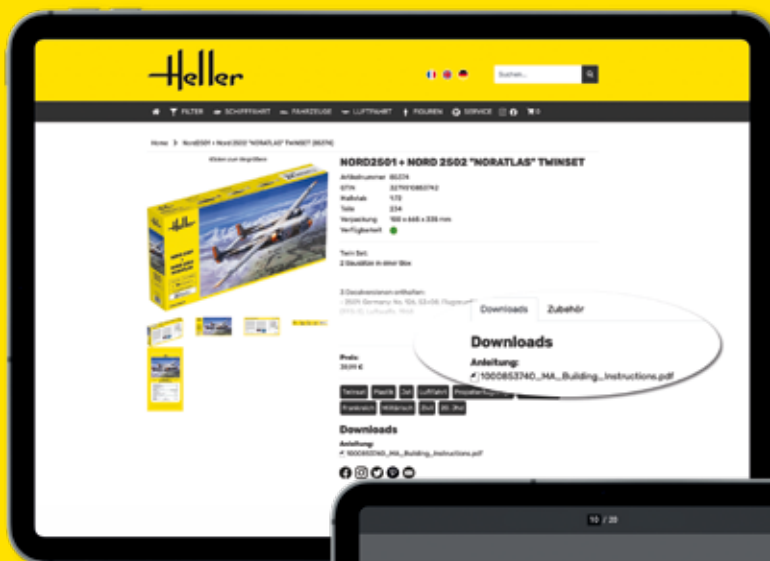

Choisissez l'article désiré et téléchargez la notice de montage.  
Choose your desired article and download the instructions.  
Wählen Sie den gewünschten Artikel und laden Sie die Anleitung herunter.

**Download all  
instructions!**

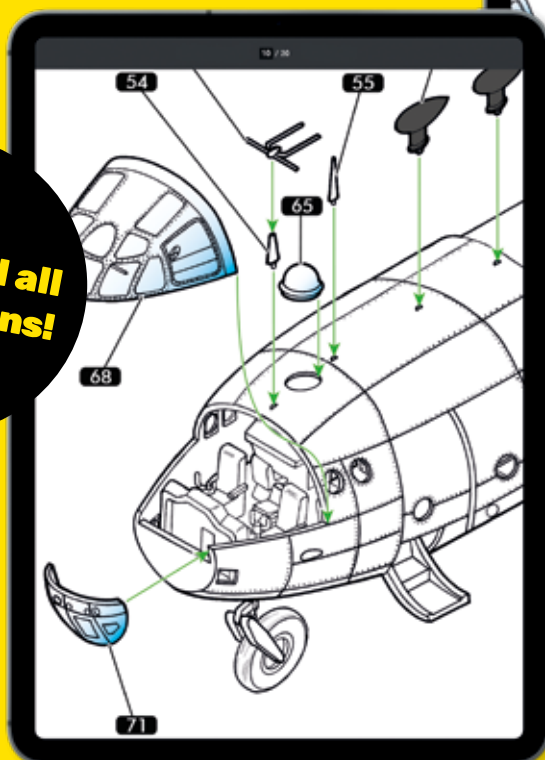

Grossissement des instructions pour  
une vue détaillée.

Enlarge the instructions for a more  
detailed view.

Vergrößern Sie die Anleitung für eine  
detailliertere Ansicht.

**Service consommateurs**  
Pour toute demande de SAV, connectez-vous  
sur notre site [www.heller.fr](http://www.heller.fr).

**Customer Service**  
For after-sales service requests,  
please contact us through our website  
[www.heller.fr](http://www.heller.fr).

**Endverbraucherservice**  
Bitte besuchen Sie uns auf [www.heller.fr](http://www.heller.fr)  
für alle Ersatzteilanfragen.

**Heller Hobby GmbH**

Erlenbacher Str. 3 • 42477 Radevormwald • GERMANY

 +49 (0) 2195-92773-0  [info@heller.fr](mailto:info@heller.fr)